



Matthew G. Bevin
Governor

COMMONWEALTH OF KENTUCKY
TRANSPORTATION CABINET
Frankfort, Kentucky 40622
www.transportation.ky.gov/

Greg Thomas
Secretary

May 23, 2018

CALL NO. 103
CONTRACT ID NO. 181401
ADDENDUM # 2

Subject: BOONE COUNTY, STP 8124 (022)
Letting May 25, 2018

- (1) Revised - Proposal Bid Items - Pages 197-201 of 201
- (2) Revised - Plan Sheets- R2A, R2B, R2C, and R2D

Proposal revisions are available at <http://transportation.ky.gov/Construction-Procurement/>.

If you have any questions, please contact us at 502-564-3500.

Sincerely,

A handwritten signature in cursive script that reads "Rachel Mills".

Rachel Mills, P.E.
Director
Division of Construction Procurement

RM:mr
Enclosures



An Equal Opportunity Employer M/F/D

PROPOSAL BID ITEMS

181401

Report Date 5/23/18

Section: 0001 - PAVING

LINE	BID CODE	ALT	DESCRIPTION	QUANTITY	UNIT	UNIT PRIC	FP	AMOUNT
0010	00003		CRUSHED STONE BASE	3,135.00	TON		\$	
0020	00005		GEOGRID REINFORCEMENT FOR SUBGRADE	7,413.00	SQYD		\$	
0030	00071		CRUSHED AGGREGATE SIZE NO 57	368.00	TON		\$	
0040	00078		CRUSHED AGGREGATE SIZE NO 2	5,116.00	TON		\$	
0050	00214		CL3 ASPH BASE 1.00D PG64-22	2,534.00	TON		\$	
0060	00219		CL4 ASPH BASE 1.00D PG76-22	1,339.00	TON		\$	
0070	00342		CL4 ASPH SURF 0.38A PG76-22	1,930.00	TON		\$	
0080	00356		ASPHALT MATERIAL FOR TACK	3.00	TON		\$	
0090	02101		CEM CONC ENT PAVEMENT-8 IN	2,087.00	SQYD		\$	
0100	02676		MOBILIZATION FOR MILL & TEXT	1.00	LS		\$	
0110	02677		ASPHALT PAVE MILLING & TEXTURING	1,203.00	TON		\$	
0120	20550ND		SAWCUT PAVEMENT	2,407.00	LF		\$	

Section: 0002 - ROADWAY

LINE	BID CODE	ALT	DESCRIPTION	QUANTITY	UNIT	UNIT PRIC	FP	AMOUNT
0130	00001		DGA BASE (REVISED: 5-23-18)	528.00	TON		\$	
0140	01000		PERFORATED PIPE-4 IN	1,457.00	LF		\$	
0150	01010		NON-PERFORATED PIPE-4 IN	124.00	LF		\$	
0160	01024		PERF PIPE HEADWALL TY 2-4 IN	2.00	EACH		\$	
0170	01310		REMOVE PIPE	26.00	LF		\$	
0180	01585		REMOVE DROP BOX INLET	1.00	EACH		\$	
0190	01705		REMOVE CURB & GUTTER BOX INLET	1.00	EACH		\$	
0200	01810		STANDARD CURB AND GUTTER	3,534.00	LF		\$	
0210	01830		STANDARD INTEGRAL CURB	73.00	LF		\$	
0220	01840		LIP INTEGRAL CURB	638.00	LF		\$	
0230	01875		STANDARD HEADER CURB	194.00	LF		\$	
0240	01904		REMOVE CURB	700.00	LF		\$	
0250	01949		MOUNTABLE MEDIAN TYPE 6A	242.00	SQYD		\$	
0260	01982		DELINEATOR FOR GUARDRAIL MONO DIRECTIONAL WHITE	13.00	EACH		\$	
0270	01984		DELINEATOR FOR BARRIER - WHITE	24.00	EACH		\$	
0280	01992		INSTALL TEMP CONC MED BARR	1,200.00	LF		\$	
0290	02002		REMOVE TEMP CONC BARRIER WALL	1,200.00	LF		\$	
0300	02003		RELOCATE TEMP CONC BARRIER	600.00	LF		\$	
0310	02014		BARRICADE-TYPE III	8.00	EACH		\$	
0320	02015		CEMENT CONCRETE ISLAND	184.00	SQYD		\$	
0330	02091		REMOVE PAVEMENT	1,085.00	SQYD		\$	
0340	02159		TEMP DITCH	1,000.00	LF		\$	
0350	02160		CLEAN TEMP DITCH	1,000.00	LF		\$	
0360	02230		EMBANKMENT IN PLACE	32,835.00	CUYD		\$	
0370	02242		WATER	577.00	MGAL		\$	
0380	02351		GUARDRAIL-STEEL W BEAM-S FACE	670.00	LF		\$	
0390	02367		GUARDRAIL END TREATMENT TYPE 1	1.00	EACH		\$	
0400	02369		GUARDRAIL END TREATMENT TYPE 2A	3.00	EACH		\$	

PROPOSAL BID ITEMS

181401

Report Date 5/23/18

LINE	BID CODE	ALT	DESCRIPTION	QUANTITY	UNIT	UNIT PRIC	FP	AMOUNT
0410	02381		REMOVE GUARDRAIL	1,242.00	LF		\$	
0420	02391		GUARDRAIL END TREATMENT TYPE 4A	1.00	EACH		\$	
0430	02429		RIGHT-OF-WAY MONUMENT TYPE 1	34.00	EACH		\$	
0440	02432		WITNESS POST	34.00	EACH		\$	
0450	02483		CHANNEL LINING CLASS II	33.00	TON		\$	
0460	02484		CHANNEL LINING CLASS III	23.00	TON		\$	
0470	02545		CLEARING AND GRUBBING (APPROXIMATELY 10.22 ACRES)	1.00	LS		\$	
0480	02562		TEMPORARY SIGNS	2,000.00	SQFT		\$	
0490	02585		EDGE KEY	1,180.00	LF		\$	
0500	02596		FABRIC-GEOTEXTILE TYPE I	83.00	SQYD		\$	
0510	02599		FABRIC-GEOTEXTILE TYPE IV	3,716.00	SQYD		\$	
0520	02625		REMOVE HEADWALL	2.00	EACH		\$	
0530	02650		MAINTAIN & CONTROL TRAFFIC	1.00	LS		\$	
0540	02690		SAFELOADING	20.00	CUYD		\$	
0550	02701		TEMP SILT FENCE	2,000.00	LF		\$	
0560	02703		SILT TRAP TYPE A	40.00	EACH		\$	
0570	02704		SILT TRAP TYPE B	40.00	EACH		\$	
0580	02705		SILT TRAP TYPE C	15.00	EACH		\$	
0590	02706		CLEAN SILT TRAP TYPE A	120.00	EACH		\$	
0600	02707		CLEAN SILT TRAP TYPE B	120.00	EACH		\$	
0610	02708		CLEAN SILT TRAP TYPE C	45.00	EACH		\$	
0620	02720		SIDEWALK-4 IN CONCRETE	2,290.00	SQYD		\$	
0630	02726		STAKING	1.00	LS		\$	
0640	02775		ARROW PANEL	2.00	EACH		\$	
0650	02900		INSTALL TEMP CRASH CUSHION	4.00	EACH		\$	
0660	03171		CONCRETE BARRIER WALL TYPE 9T	1,200.00	LF		\$	
0670	04936		MAINTAIN SIGNAL OPERATION	1.00	LS		\$	
0680	05950		EROSION CONTROL BLANKET	499.00	SQYD		\$	
0690	05952		TEMP MULCH	25,000.00	SQYD		\$	
0700	05953		TEMP SEEDING AND PROTECTION	25,000.00	SQYD		\$	
0710	05963		INITIAL FERTILIZER	.50	TON		\$	
0720	05964		20-10-10 FERTILIZER	.80	TON		\$	
0730	05985		SEEDING AND PROTECTION	13,972.00	SQYD		\$	
0740	05990		SODDING	2,007.00	SQYD		\$	
0750	05992		AGRICULTURAL LIMESTONE	6.00	TON		\$	
0760	06510		PAVE STRIPING-TEMP PAINT-4 IN	50,000.00	LF		\$	
0770	06514		PAVE STRIPING-PERM PAINT-4 IN	19,174.00	LF		\$	
0780	06530		PAVE STRIPING REMOVAL-4 IN	5,000.00	LF		\$	
0790	06533		PAVE STRIPING REMOVAL-12 IN	200.00	LF		\$	
0800	06550		PAVE STRIPING-TEMP REM TAPE-W	1,500.00	LF		\$	
0810	06551		PAVE STRIPING-TEMP REM TAPE-Y	1,000.00	LF		\$	
0820	06565		PAVE MARKING-THERMO X-WALK-6 IN	1,534.00	LF		\$	
0830	06567		PAVE MARKING-THERMO STOP BAR-12IN	329.00	LF		\$	
0840	06571		PAVE MARKING-PAINT PARKING LOT	140.00	LF		\$	
0850	06572		PAVE MARKING-DOTTED LANE EXTEN	80.00	LF		\$	
0860	06573		PAVE MARKING-THERMO STR ARROW	16.00	EACH		\$	
0870	06574		PAVE MARKING-THERMO CURV ARROW	50.00	EACH		\$	
0880	06575		PAVE MARKING-THERMO COMB ARROW	2.00	EACH		\$	
0890	06588		PAVEMENT MARKER TY IVA-BY TEMP	100.00	EACH		\$	

PROPOSAL BID ITEMS

REVISED ADDENDUM #2: 5-23-18

181401

Page 3 of 5

Report Date 5/23/18

LINE	BID CODE	ALT	DESCRIPTION	QUANTITY	UNIT	UNIT PRIC	FP	AMOUNT
0900	06589		PAVEMENT MARKER TYPE V-MW	100.00	EACH		\$	
0910	06591		PAVEMENT MARKER TYPE V-BY	98.00	EACH		\$	
0920	06598		PAVEMENT MARKING REMOVAL	100.00	SQFT		\$	
0930	06600		REMOVE PAVEMENT MARKER TYPE V	80.00	EACH		\$	
0940	08901		CRASH CUSHION TY VI CLASS BT TL2	2.00	EACH		\$	
0950	10020NS		FUEL ADJUSTMENT	15,318.00	DOLL	\$1.00	\$	\$15,318.00
0960	10030NS		ASPHALT ADJUSTMENT	22,687.00	DOLL	\$1.00	\$	\$22,687.00
0970	20072ES805		GRANULAR EMBANKMENT	1,480.00	TON		\$	
0980	21373ND		REMOVE SIGN	1.00	EACH		\$	
0990	23158ES505		DETECTABLE WARNINGS	672.00	SQFT		\$	
1000	23275EN11F		TURF REINFORCEMENT MAT 2	883.00	SQYD		\$	
1010	23322EC		AGGREGATE SIZE NO. 57	170.00	CUYD		\$	
1020	24631EC		BARCODE SIGN INVENTORY	131.00	EACH		\$	
1030	24910EC		PAVE MARKING-THERMO NO LEFT TURN	4.00	EACH		\$	

Section: 0003 - DRAINAGE

LINE	BID CODE	ALT	DESCRIPTION	QUANTITY	UNIT	UNIT PRIC	FP	AMOUNT
1040	00520		STORM SEWER PIPE-12 IN	42.00	LF		\$	
1050	00521		STORM SEWER PIPE-15 IN	603.00	LF		\$	
1060	00522		STORM SEWER PIPE-18 IN	564.00	LF		\$	
1070	00524		STORM SEWER PIPE-24 IN	24.00	LF		\$	
1080	00526		STORM SEWER PIPE-30 IN	303.00	LF		\$	
1090	00556		STORM SEWER PIPE-30 IN EQUIV	4.00	LF		\$	
1100	01200		PIPE CULVERT HEADWALL-12 IN	1.00	EACH		\$	
1110	01202		PIPE CULVERT HEADWALL-15 IN	2.00	EACH		\$	
1120	01204		PIPE CULVERT HEADWALL-18 IN	2.00	EACH		\$	
1130	01210		PIPE CULVERT HEADWALL-30 IN	2.00	EACH		\$	
1140	01450		S & F BOX INLET-OUTLET-18 IN	1.00	EACH		\$	
1150	01456		CURB BOX INLET TYPE A	12.00	EACH		\$	
1160	01480		CURB BOX INLET TYPE B	1.00	EACH		\$	
1170	01496		DROP BOX INLET TYPE 3	1.00	EACH		\$	
1180	01529		DROP BOX INLET TYPE 6D	3.00	EACH		\$	
1190	01544		DROP BOX INLET TYPE 11	1.00	EACH		\$	
1200	01580		DROP BOX INLET TYPE 15	2.00	EACH		\$	
1210	01719		ADJUST INLET	1.00	EACH		\$	
1220	01740		CORED HOLE DRAINAGE BOX CON-4 IN	3.00	EACH		\$	
1230	01743		CORED HOLE DRAINAGE BOX CON-12 IN	1.00	EACH		\$	
1240	01756		MANHOLE TYPE A	4.00	EACH		\$	
1250	01767		MANHOLE TYPE C	6.00	EACH		\$	
1260	02600		FABRIC GEOTEXTILE TY IV FOR PIPE	2,326.00	SQYD	\$2.00	\$	\$4,652.00
1270	23822EC		CORED HOLE DRAINAGE BOX CON-15 IN	2.00	EACH		\$	
1280	24814EC		PIPELINE INSPECTION	1,540.00	LF		\$	

Section: 0004 - SEWER

LINE	BID CODE	ALT	DESCRIPTION	QUANTITY	UNIT	UNIT PRIC	FP	AMOUNT
------	----------	-----	-------------	----------	------	-----------	----	--------

PROPOSAL BID ITEMS

181401

Report Date 5/23/18

LINE	BID CODE	ALT	DESCRIPTION	QUANTITY	UNIT	UNIT PRIC	FP	AMOUNT
1290	15000		S BYPASS PUMPING	1.00	EACH		\$	
1300	15086		S LATERAL CLEANOUT	5.00	EACH		\$	
1310	15090		S LATERAL SHORT SIDE 06 INCH	5.00	EACH		\$	
1320	15092		S MANHOLE	6.00	EACH		\$	
1330	15093		S MANHOLE ABANDON/REMOVE	1.00	EACH		\$	
1340	15095		S MANHOLE CASTING STANDARD	5.00	EACH		\$	
1350	15096		S MANHOLE CASTING WATERTIGHT	1.00	EACH		\$	
1360	15104		S PIPE DUCTILE IRON 08 INCH	633.00	LF		\$	

Section: 0005 - SIGNING

LINE	BID CODE	ALT	DESCRIPTION	QUANTITY	UNIT	UNIT PRIC	FP	AMOUNT
1370	06406		SBM ALUM SHEET SIGNS .080 IN	381.00	SQFT		\$	
1380	06407		SBM ALUM SHEET SIGNS .125 IN	146.00	SQFT		\$	
1390	06410		STEEL POST TYPE 1	831.00	LF		\$	

Section: 0006 - SIGNALIZATION

LINE	BID CODE	ALT	DESCRIPTION	QUANTITY	UNIT	UNIT PRIC	FP	AMOUNT
1400	04792		CONDUIT-1 IN	75.00	LF		\$	
1402	04793		CONDUIT-1 1/4 IN (PLANNING LOOPS) (ADDED: 5-15-18)	10.00	LF		\$	
1404	04795		CONDUIT-2 IN (PLANNING LOOPS) (ADDED: 5-15-18)	10.00	LF		\$	
1410	04811		ELECTRICAL JUNCTION BOX TYPE B	5.00	EACH		\$	
1411	04811		ELECTRICAL JUNCTION BOX TYPE B (PLANNING LOOPS) (ADDED: 5-15-18)	1.00	EACH		\$	
1420	04820		TRENCHING AND BACKFILLING	245.00	LF		\$	
1421	04820		TRENCHING AND BACKFILLING (PLANNING LOOPS) (ADDED: 5-15-18)	15.00	LF		\$	
1430	04830		LOOP WIRE	3,840.00	LF		\$	
1431	04830		LOOP WIRE (PLANNING LOOPS) (ADDED: 5-15-18)	1,000.00	LF		\$	
1440	04844		CABLE-NO. 14/5C	3,513.00	LF		\$	
1450	04845		CABLE-NO. 14/7C	709.00	LF		\$	
1460	04850		CABLE-NO. 14/1 PAIR	2,549.00	LF		\$	
1470	04885		MESSENGER-10800 LB	575.00	LF		\$	
1480	04895		LOOP SAW SLOT AND FILL	1,320.00	LF		\$	
1481	04895		LOOP SAW SLOT AND FILL (PLANNING LOOPS) (ADDED: 5-15-18)	185.00	LF		\$	
1490	04931		INSTALL CONTROLLER TYPE 170	2.00	EACH		\$	
1500	04932		INSTALL STEEL STRAIN POLE	8.00	EACH		\$	
1510	06472		INSTALL SPAN MOUNTED SIGN	4.00	EACH		\$	
1520	20093NS835		INSTALL PEDESTRIAN HEAD-LED	12.00	EACH		\$	

PROPOSAL BID ITEMS

181401

Report Date 5/23/18

LINE	BID CODE	ALT	DESCRIPTION	QUANTITY	UNIT	UNIT PRIC	FP	AMOUNT
1530	20094ES835		TEMP RELOCATION OF SIGNAL HEAD	24.00	EACH		\$	
1540	20188NS835		INSTALL LED SIGNAL-3 SECTION	8.00	EACH		\$	
1550	20189NS835		INSTALL LED SIGNAL-5 SECTION	4.00	EACH		\$	
1560	20266ES835		INSTALL LED SIGNAL- 4 SECTION	3.00	EACH		\$	
1565	20360ES818		WOOD POST (PLANNING LOOPS) (ADDED: 5-15-18)	1.00	EACH		\$	
1570	20390NS835		INSTALL COORDINATING UNIT	3.00	EACH		\$	
1575	20468EC		ELECTRICAL JUNCTION BOX-10 X 8 X 4 (PLANNING LOOPS) (ADDED: 5-15-18)	1.00	EACH		\$	
1580	21743NN		INSTALL PEDESTRIAN DETECTOR	12.00	EACH		\$	
1590	23157EN		TRAFFIC SIGNAL POLE BASE	32.44	CUYD		\$	
1600	23222EC		INSTALL SIGNAL PEDESTAL	6.00	EACH		\$	
1610	24900EC		PVC CONDUIT-1 1/4 IN-SCHEDULE 80	285.00	LF		\$	
1620	24901EC		PVC CONDUIT-2 IN-SCHEDULE 80	105.00	LF		\$	
1630	24955ED		REMOVE SIGNAL EQUIPMENT	1.00	EACH		\$	

Section: 0007 - WATERLINE

LINE	BID CODE	ALT	DESCRIPTION	QUANTITY	UNIT	UNIT PRIC	FP	AMOUNT
1640	14008		W ENCASMENT STEEL BORED RANGE 3	43.00	LF		\$	
1650	14010		W ENCASMENT STEEL BORED RANGE 5	67.00	LF		\$	
1660	14019		W FIRE HYDRANT ASSEMBLY	1.00	EACH		\$	
1670	14020		W FIRE HYDRANT RELOCATE	4.00	EACH		\$	
1680	14030		W METER RELOCATE	1.00	EACH		\$	
1690	14036		W PIPE DUCTILE IRON 06 INCH	115.00	LF		\$	
1700	14039		W PIPE DUCTILE IRON 12 INCH	1,394.00	LF		\$	
1710	14074		W PLUG EXISTING MAIN	2.00	EACH		\$	
1720	14090		W TAPPING SLEEVE AND VALVE SIZE 2	2.00	EACH		\$	
1730	14094		W TIE-IN 06 INCH	1.00	EACH		\$	
1740	14097		W TIE-IN 12 INCH	1.00	EACH		\$	
1750	14105		W VALVE 06 INCH	2.00	EACH		\$	
1760	14108		W VALVE 12 INCH	3.00	EACH		\$	
1770	14113		W VALVE BOX ADJUST	5.00	EACH		\$	
1780	14120		W VALVE CUT-IN 12 INCH	1.00	EACH		\$	
1790	14149		W SERV COPPER SHORT SIDE 1 IN	1.00	EACH		\$	
1800	15094		S MANHOLE ADJUST TO GRADE	3.00	EACH		\$	

Section: 0008 - DEMOBILIZATION &/OR MOBILIZATION

LINE	BID CODE	ALT	DESCRIPTION	QUANTITY	UNIT	UNIT PRIC	FP	AMOUNT
1810	02568		MOBILIZATION	1.00	LS		\$	
1820	02569		DEMOBILIZATION	1.00	LS		\$	

TYPICAL SECTION KY 842

COUNTY OF	ITEM NO.	SHEET NO.
BOONE	6-367.00	R2A

NEW CONSTRUCTION WITH ASPHALT PAVEMENT
TRAFFIC LANES

- CRUSHED AGGREGATE NO. 2
SEE GEOTECHNICAL REPORT FOR
GEOTEXTILE FABRIC RECOMMENDATIONS
- 12" DEPTH
- CRUSHED STONE BASE
- 4" DEPTH
- CL3 ASPH BASE 1.00D PG64-22
- 3" DEPTH
- CL3 ASPH BASE 1.00D PG64-22
- 3 3/4" DEPTH
- CL4 ASPH BASE 1.00D PG76-22
- 3" DEPTH
- CL4 ASPH SURFACE 0.38A PG76-22
- 1 1/4" DEPTH

- SIDEWALK**
- DGA BASE
 - 4" DEPTH
 - SIDEWALK-4 IN CONCRETE
 - 4" DEPTH

- MILL AND OVERLAY**
- ASPHALT PAVE MILLING AND TEXTURING
 - 1 1/4" DEPTH
 - CL4 ASPH SURFACE 0.38A PG76-22
 - 1 1/4" DEPTH

NOTES

- 1 SEE CROSS SECTIONS FOR SLOPES. USE EROSION CONTROL BLANKET ON SLOPES STEEPER THAN 4:1.
- 2 STANDARD CURB AND GUTTER
- 3 SODDING
- 4 CURB RETURN NOT SHOWN
- 5 SEE PAVEMENT DETAILS FOR MEDIAN LOCATION
- 6 WIDEN SHOULDERS AS SHOWN WHERE INSTALLING GUARDRAIL. FOLLOW GUARDRAIL STANDARD SHOULDER FLARES WHERE REQUIRED.

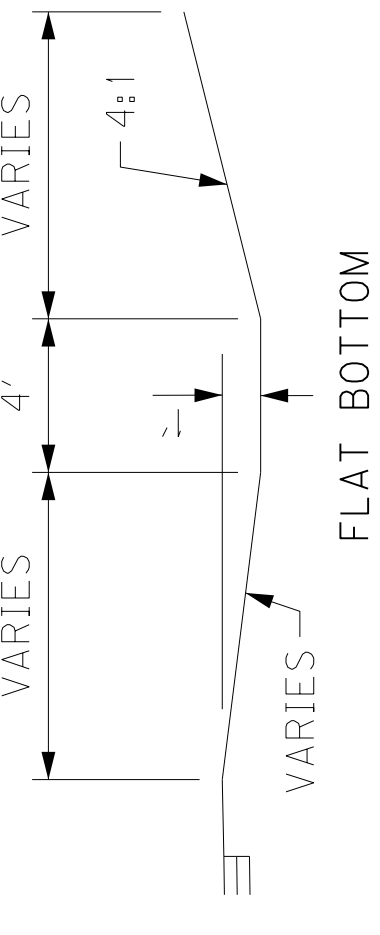

DETAIL "H"
SEE CROSS SECTIONS FOR DITCH DIMENSIONS AND LOCATIONS

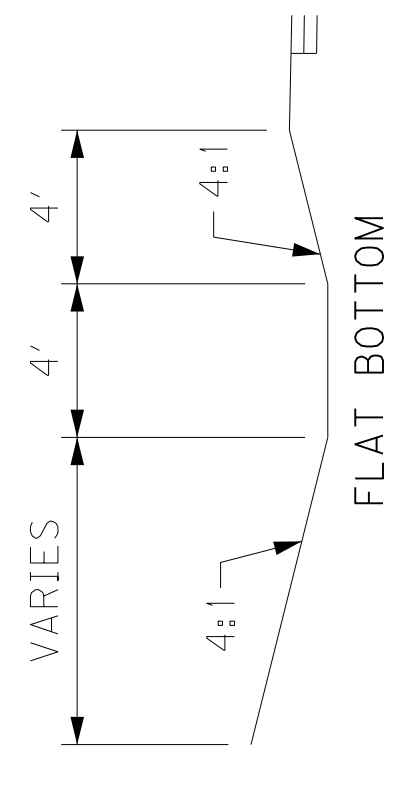

DETAIL "G"
SEE CROSS SECTIONS FOR DITCH DIMENSIONS AND LOCATIONS

FOR DETAILS SEE SHEET R2B

TYPICAL SECTIONS
KY 842

SCALE: NTS

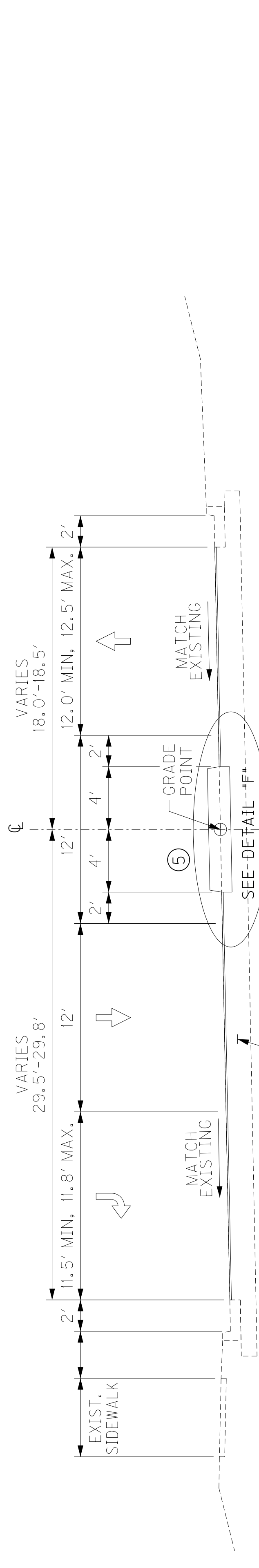

EXISTING PAVEMENT - **KY-842 SUPERELEVATED SECTION**
STA. 149+09.61 TO STA. 150+48.00
STA. 150+48.00 TO STA. 153+25.00 - MILL AND OVERLAY

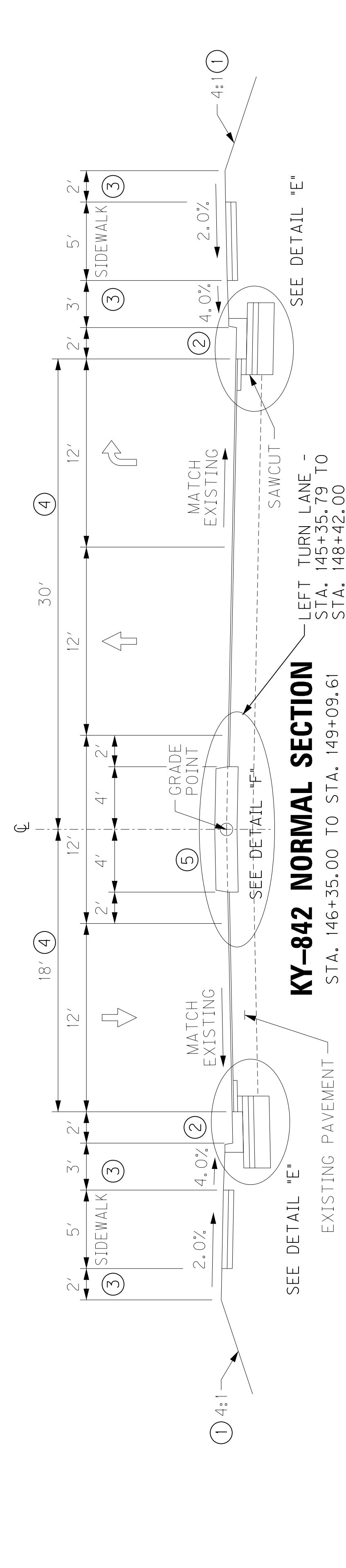

KY-842 NORMAL SECTION
STA. 146+35.00 TO STA. 149+09.61
LEFT TURN LANE -
STA. 145+35.79 TO
STA. 148+42.00

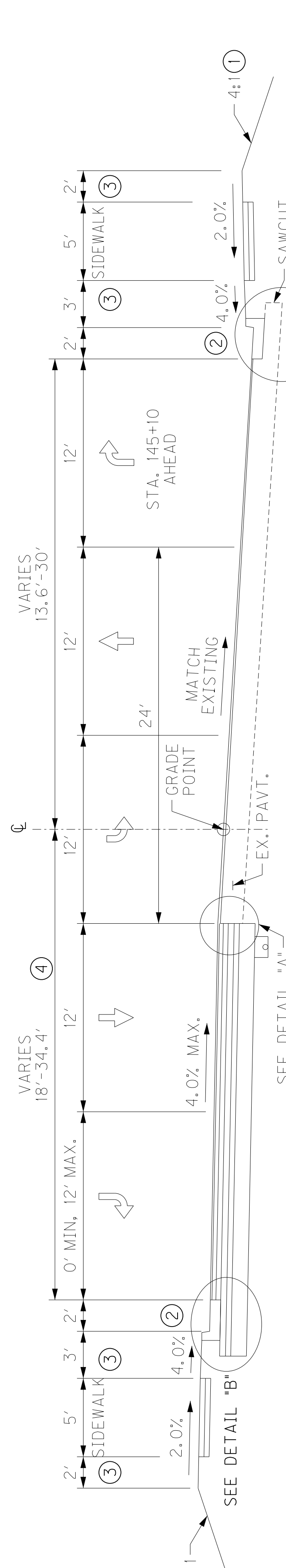

KY-842 SUPERELEVATED SECTION
STA. 143+56.90 TO STA. 146+35.00

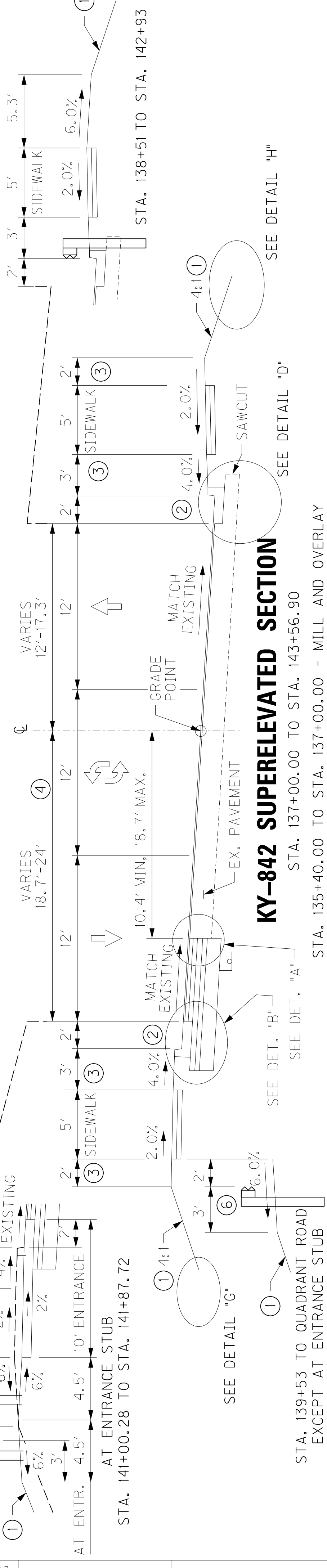

KY-842 SUPERELEVATED SECTION
STA. 137+00.00 TO STA. 143+56.90
STA. 135+40.00 TO STA. 137+00.00 - MILL AND OVERLAY

STA. 139+53 TO QUADRANT ROAD
EXCEPT AT ENTRANCE STUB

TYPICAL SECTION QUADRANT ROAD AND ENTRANCES

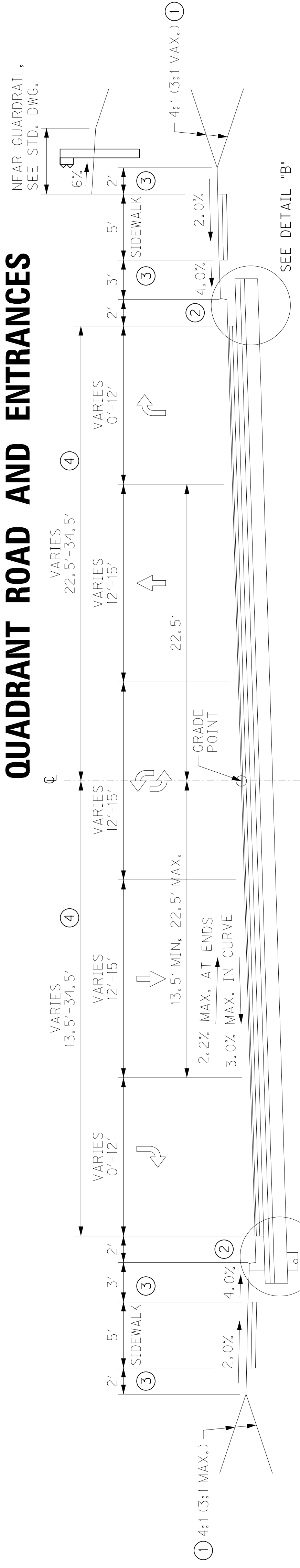

QUADRANT ROAD - SUPERELEVATED SECTION

QUADRANT ROAD - STA. 300+30.61 TO STA. 307+08.00

COMMERCIAL CONCRETE ENTRANCES

NOTE: APPLIES TO ALL US 42 & KY 842 ENTRANCES ARE CONCRETE FROM E/P TO BACK OF WALK (SEE STANDARD DRAWING RPM-152-08)
CRUSHED STONE BASE
CEMENT CONCRETE ENTRANCE PAVEMENT-8 IN 8' DEPTH

COMMERCIAL ASPHALT ENTRANCES

NOTE: ALL US 42 & KY 842 ENTRANCES ARE CONCRETE FROM E/P TO BACK OF WALK
CRUSHED STONE BASE
CL4 ASPH BASE 1,000 PG76-22
CL4 ASPH SURFACE 0.38A PG76-22
COMMERCIAL AGGREGATE ENTRANCES
CRUSHED AGGREGATE NO. 57
12' DEPTH

NOTES

- SEE CROSS SECTIONS FOR SLOPES. USE EROSION CONTROL BLANKET ON SLOPES STEEPER THAN 4:1.
- STANDARD CURB AND GUTTER
- SODDING
- CURB RETURN NOT SHOWN

CONCRETE ENTRANCE NORMAL SECTION

(ALL ENTRANCES FROM E/P TO BACK OF WALK)
US-42 - STA. 468+71.60 LT
US-42 - STA. 471+28.00 LT
KY-842 - STA. 144+53.32 RT
KY-842 - STA. 146+27.87 RT

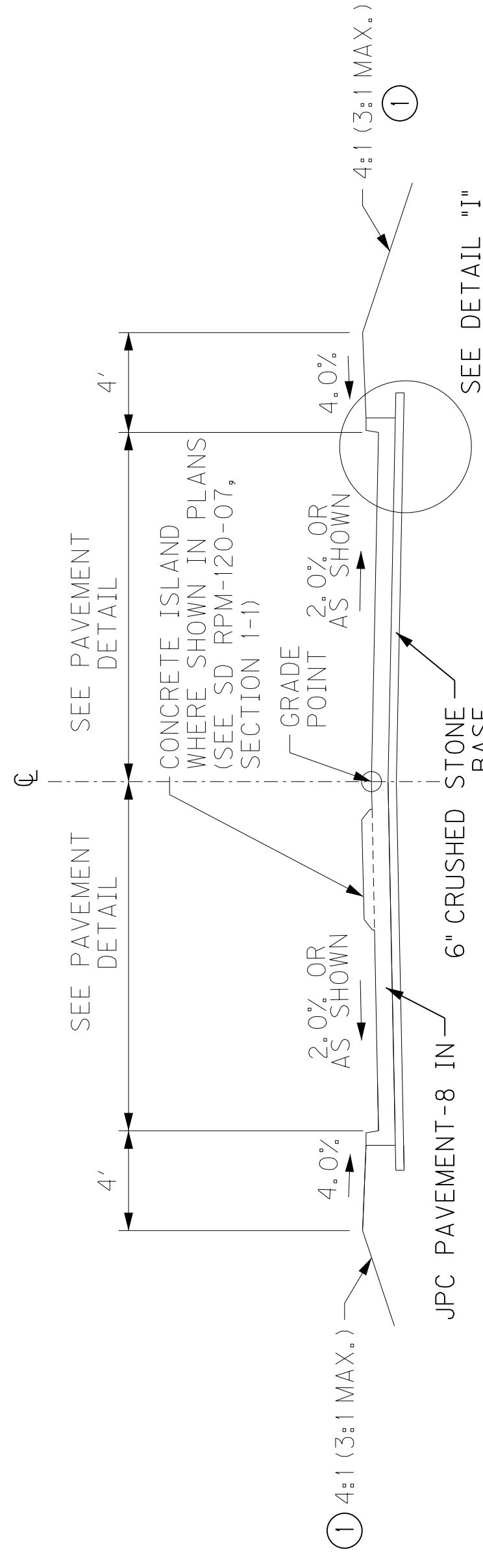

ASPHALT ENTRANCE NORMAL SECTION

NOTE: CONCRETE ENTRANCE SECTION APPLIES FROM E/P TO BACK OF WALK
US-42 - STA. 470+41.30 RT
KY-842 - STA. 147+30.00 LT

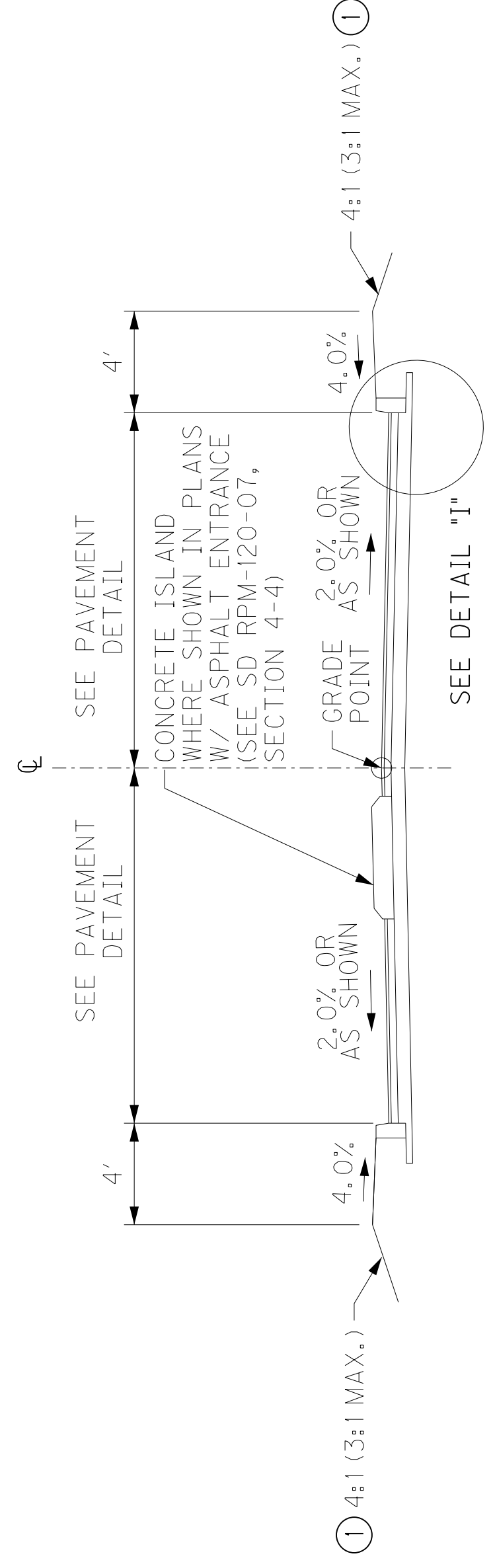

AGGREGATE ENTRANCE NORMAL SECTION

APPLIES FROM END OF CURB RETURN RADIUS
QUADRANT ROAD - STA. 303+85.48 RT

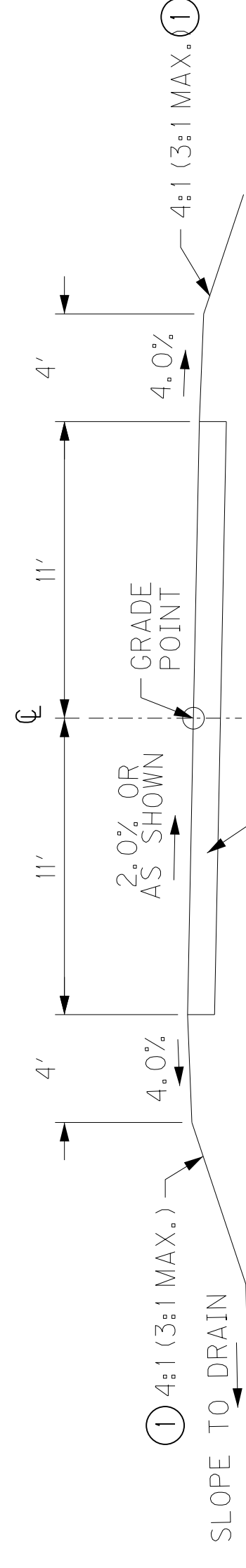

DETAIL "A"

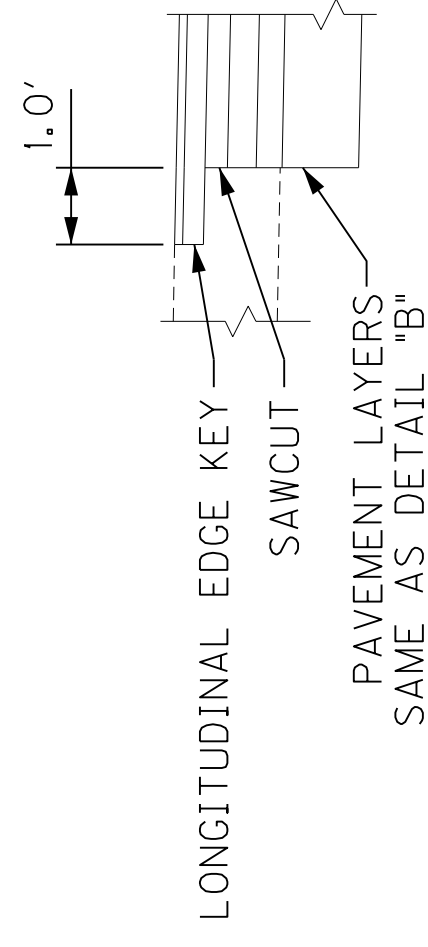

LONGITUDINAL EDGE KEY
SAWCUT
PAVEMENT LAYERS
SAME AS DETAIL "B"

DETAIL "B"

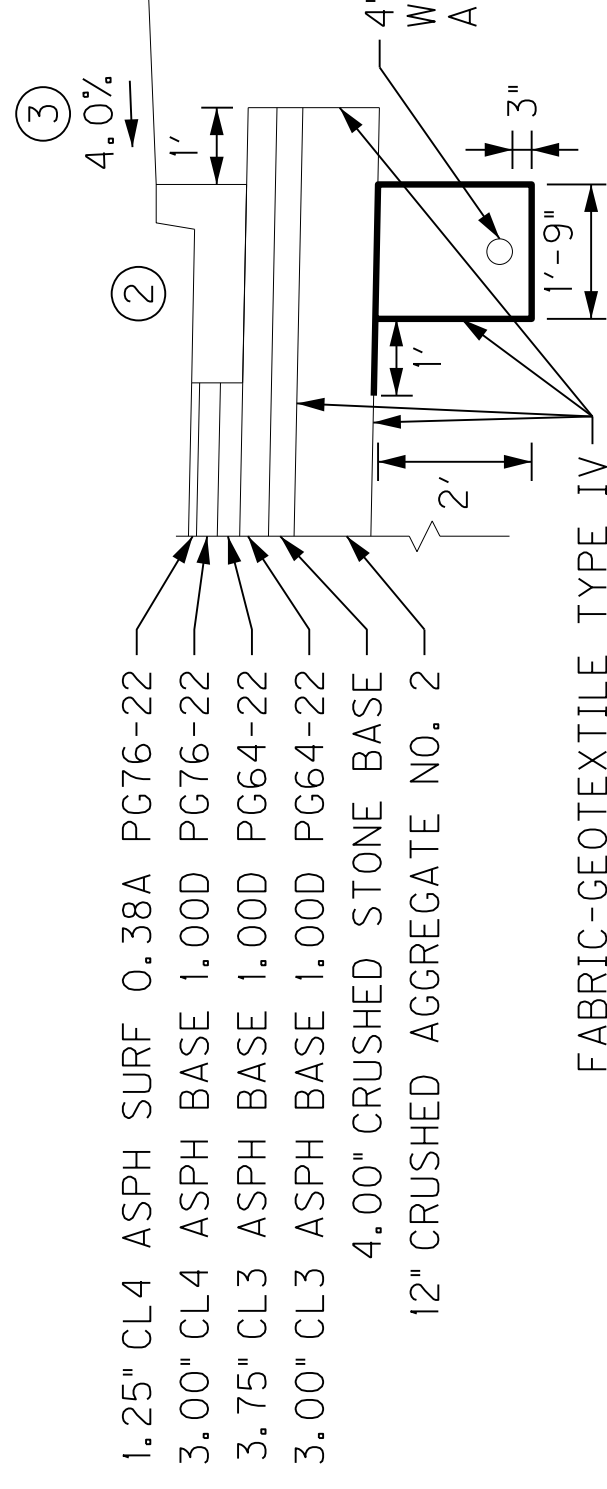

FABRIC-GEOTEXTILE TYPE IV

DETAIL "D"

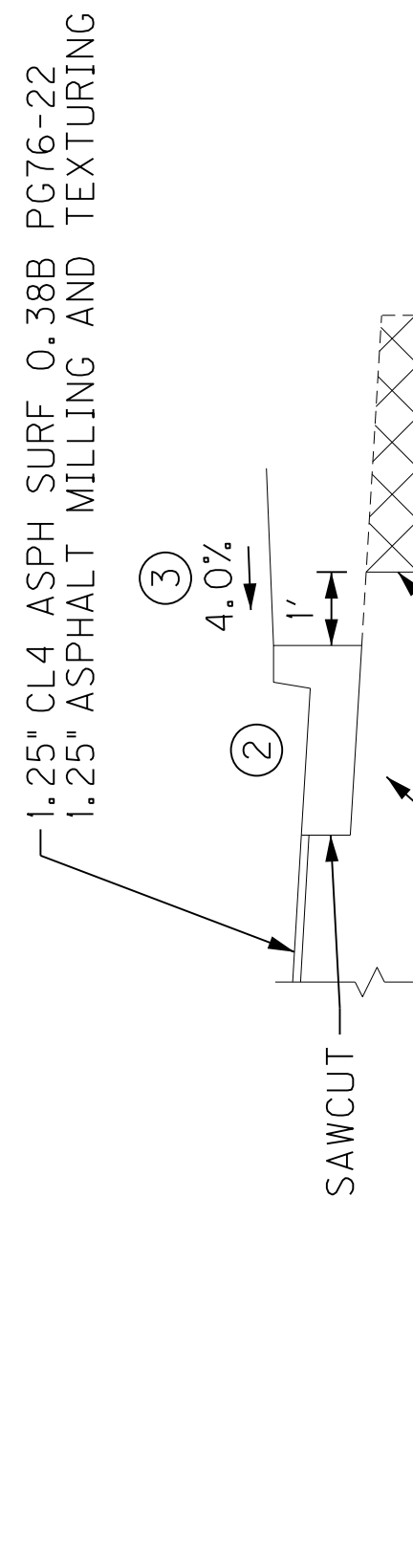

EXISTING PAVEMENT TO REMAIN
SAWCUT
REMOVE EXISTING PAVEMENT

DETAIL "E"

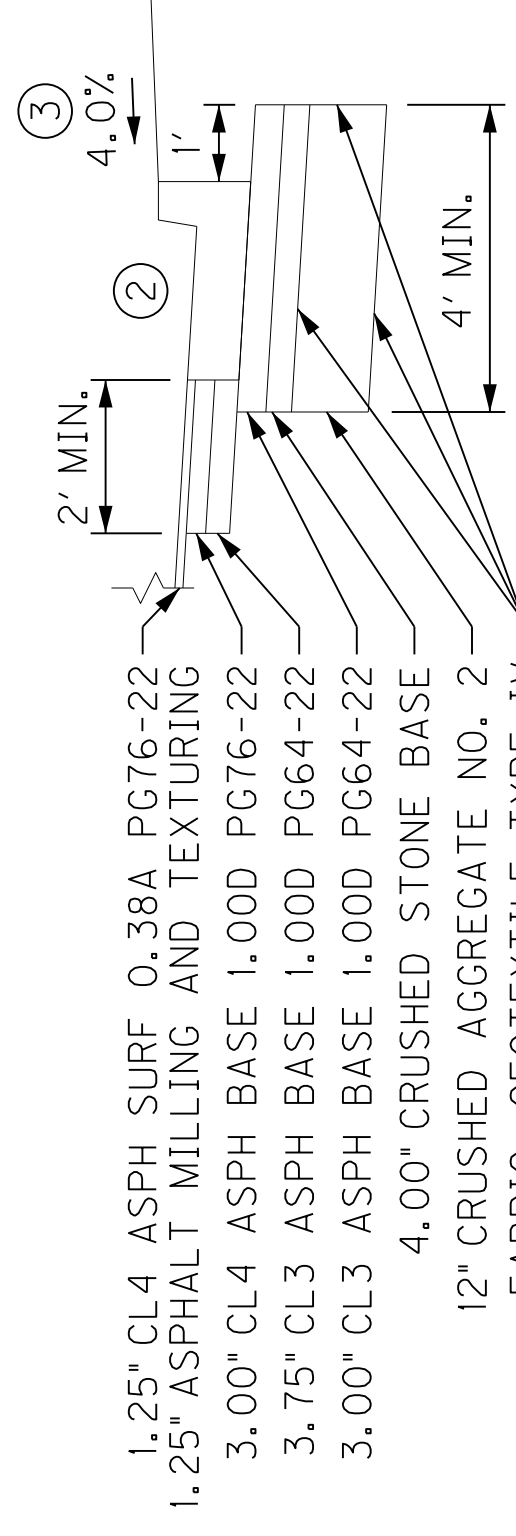

FABRIC, GEOTEXTILE TYPE IV

DETAIL "E"

COUNTY OF	ITEM NO.	SHEET NO.
BOONE	6-367.00	R2B

NEW CONSTRUCTION WITH ASPHALT PAVEMENT TRAFFIC LANES

CRUSHED AGGREGATE NO. 2
SEE GEOTECHNICAL REPORT FOR GEOTEXTILE FABRIC RECOMMENDATIONS
CRUSHED STONE BASE
CL3 ASPH BASE 1,000 PG64-22
CL3 ASPH BASE 1,000 PG64-22
CL4 ASPH BASE 1,000 PG76-22
CL4 ASPH SURFACE 0.38A PG76-22
SIDEWALK
DGA BASE
SIDEWALK-4 IN CONCRETE
12" DEPTH
4" DEPTH
3" DEPTH
3 3/4" DEPTH
3" DEPTH
1 1/4" DEPTH
4" DEPTH
4" DEPTH

DETAIL "I"
ENTRANCES

SCALE: NTS

TYPICAL SECTIONS
QUADRANT ROAD AND ENTRANCES

TYPICAL SECTION QUADRANT ROAD AND ENTRANCES

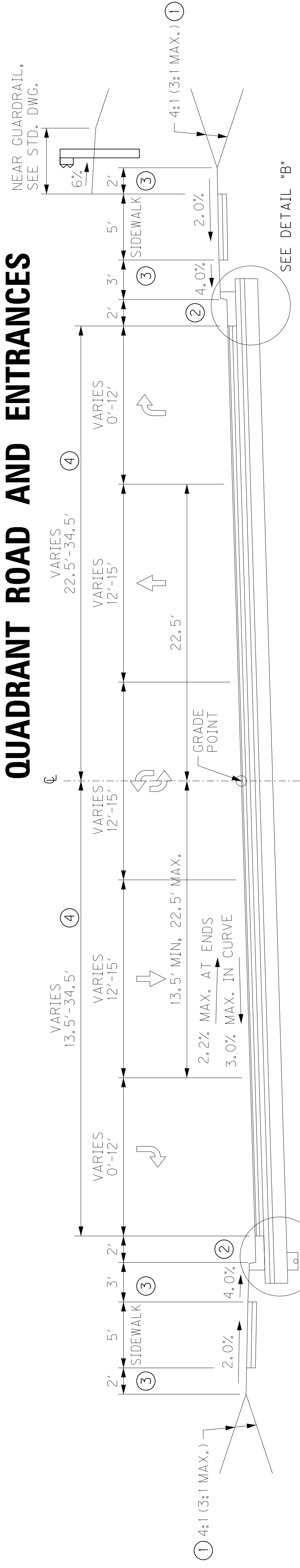

QUADRANT ROAD - SUPERELEVATED SECTION

QUADRANT ROAD - STA. 300+30.61 TO STA. 307+08.00

COMMERCIAL CONCRETE ENTRANCES

NOTE: APPLIES TO ALL US 42 & KY 842 ENTRANCES FROM E/P TO BACK OF WALK (SEE STANDARD DRAWING RPM-152-08)
CRUSHED STONE BASE
CEMENT CONCRETE ENTRANCE PAVEMENT-8 IN 8" DEPTH

COMMERCIAL ASPHALT ENTRANCES

NOTE: ALL US 42 & KY 842 ENTRANCES ARE CONCRETE FROM E/P TO BACK OF WALK
CRUSHED STONE BASE
CL4 ASPH BASE 1,000 PG64-22
CL4 ASPH SURFACE 0.38A PG76-22

COMMERCIAL AGGREGATE ENTRANCES

CRUSHED AGGREGATE NO. 57
12" DEPTH

NOTES

- SEE CROSS SECTIONS FOR SLOPES. USE EROSION CONTROL BLANKET ON SLOPES STEEPER THAN 4:1.
- STANDARD CURB AND GUTTER
- SODDING
- CURB RETURN NOT SHOWN

CONCRETE ENTRANCE NORMAL SECTION

(ALL ENTRANCES FROM E/P TO BACK OF WALK)
US-42 - STA. 468+71.60 LT
US-42 - STA. 471+28.00 LT
KY-842 - STA. 144+53.32 RT
KY-842 - STA. 146+27.87 RT

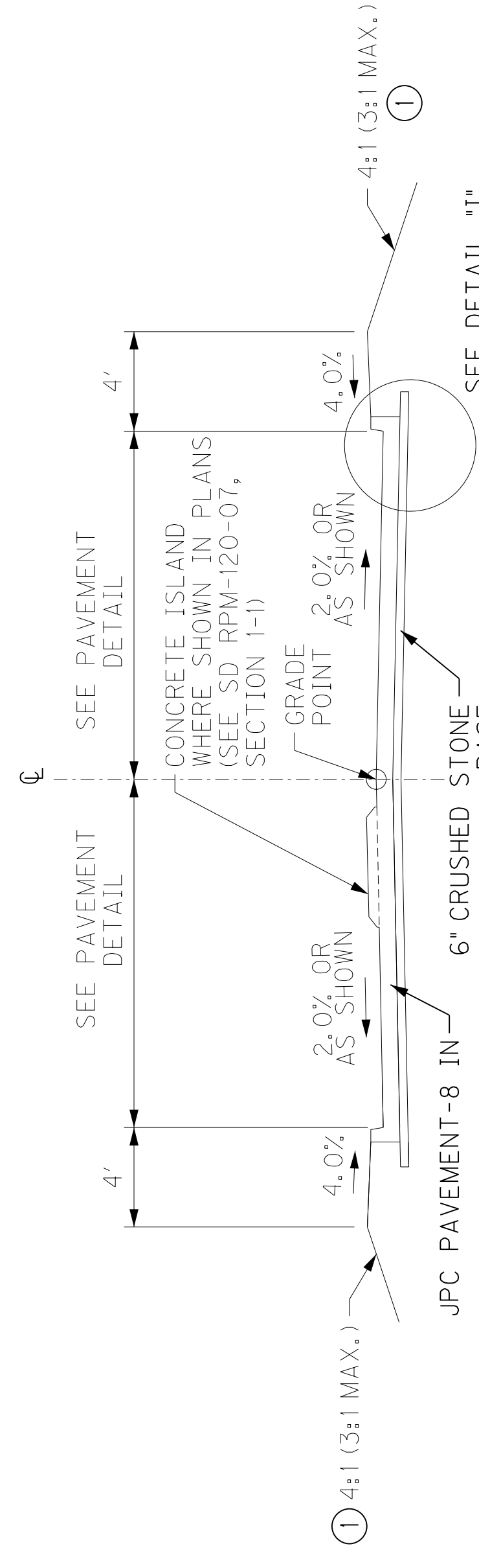

ASPHALT ENTRANCE NORMAL SECTION

NOTE: CONCRETE ENTRANCE SECTION APPLIES FROM E/P TO BACK OF WALK
US-42 - STA. 470+41.30 RT
KY-842 - STA. 147+30.00 LT

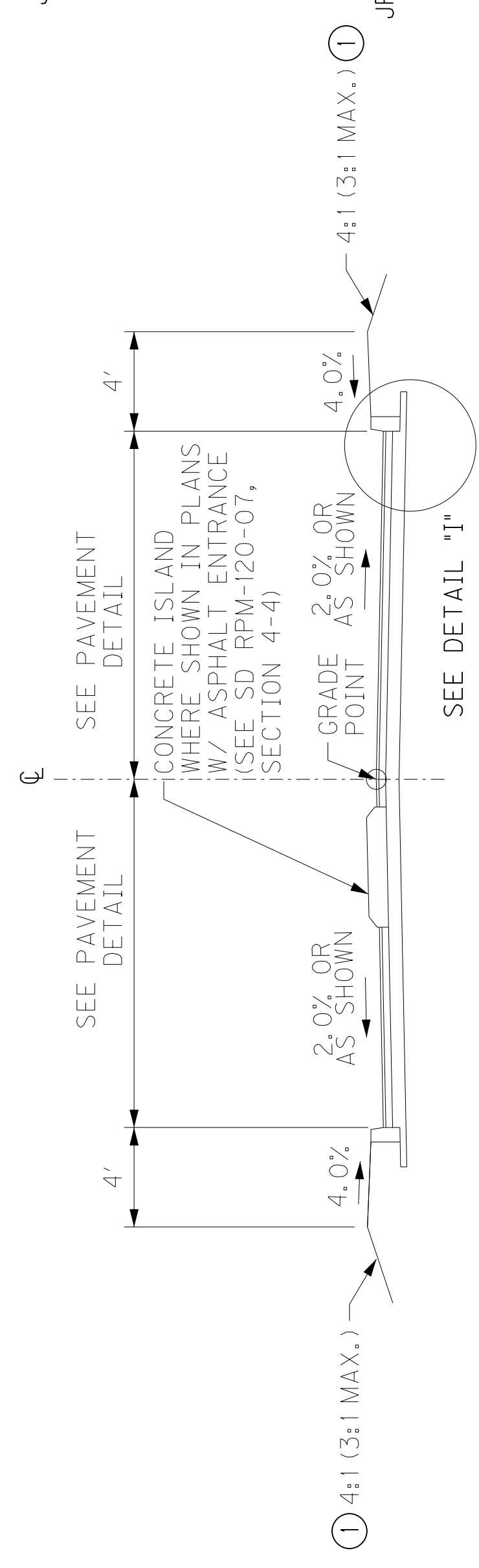

AGGREGATE ENTRANCE NORMAL SECTION

APPLIES FROM END OF CURB RETURN RADIUS
QUADRANT ROAD - STA. 303+85.48 RT

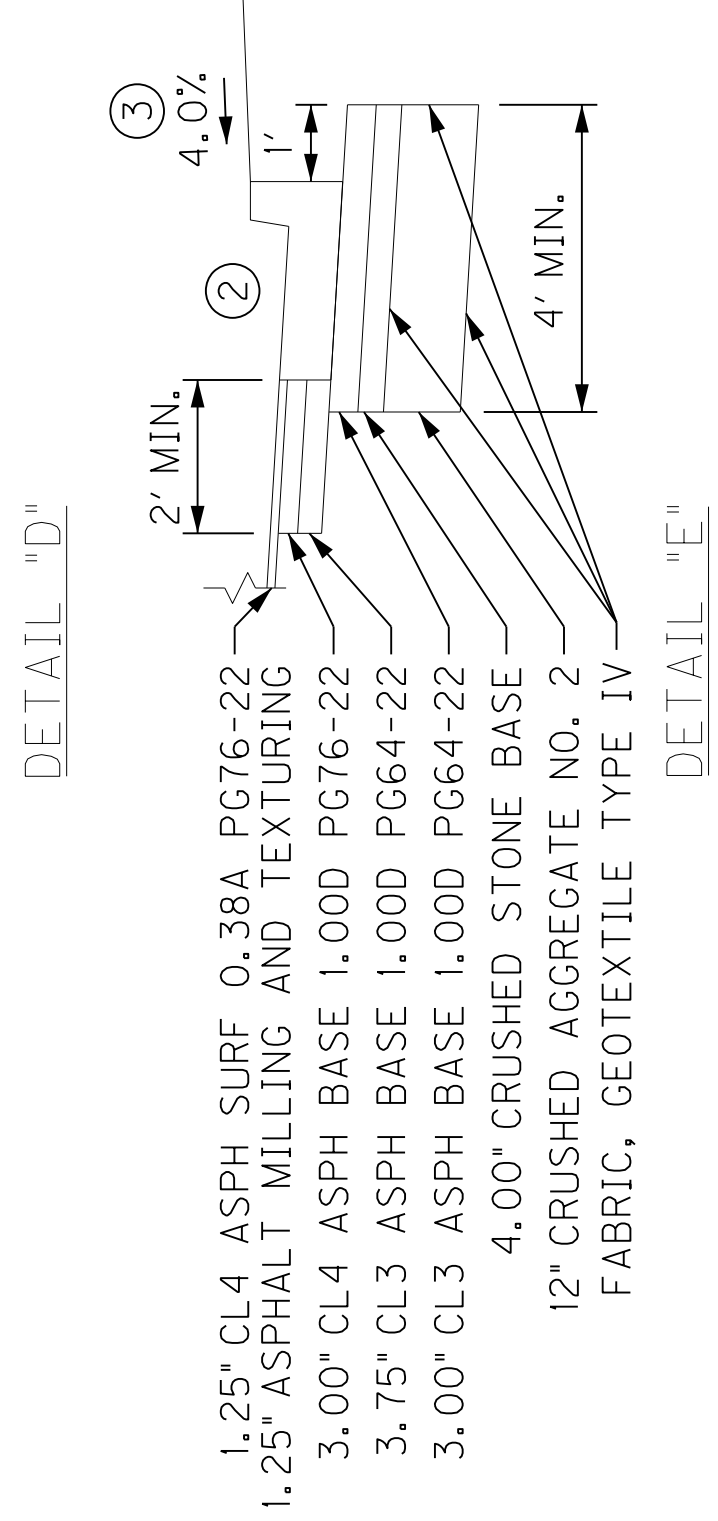
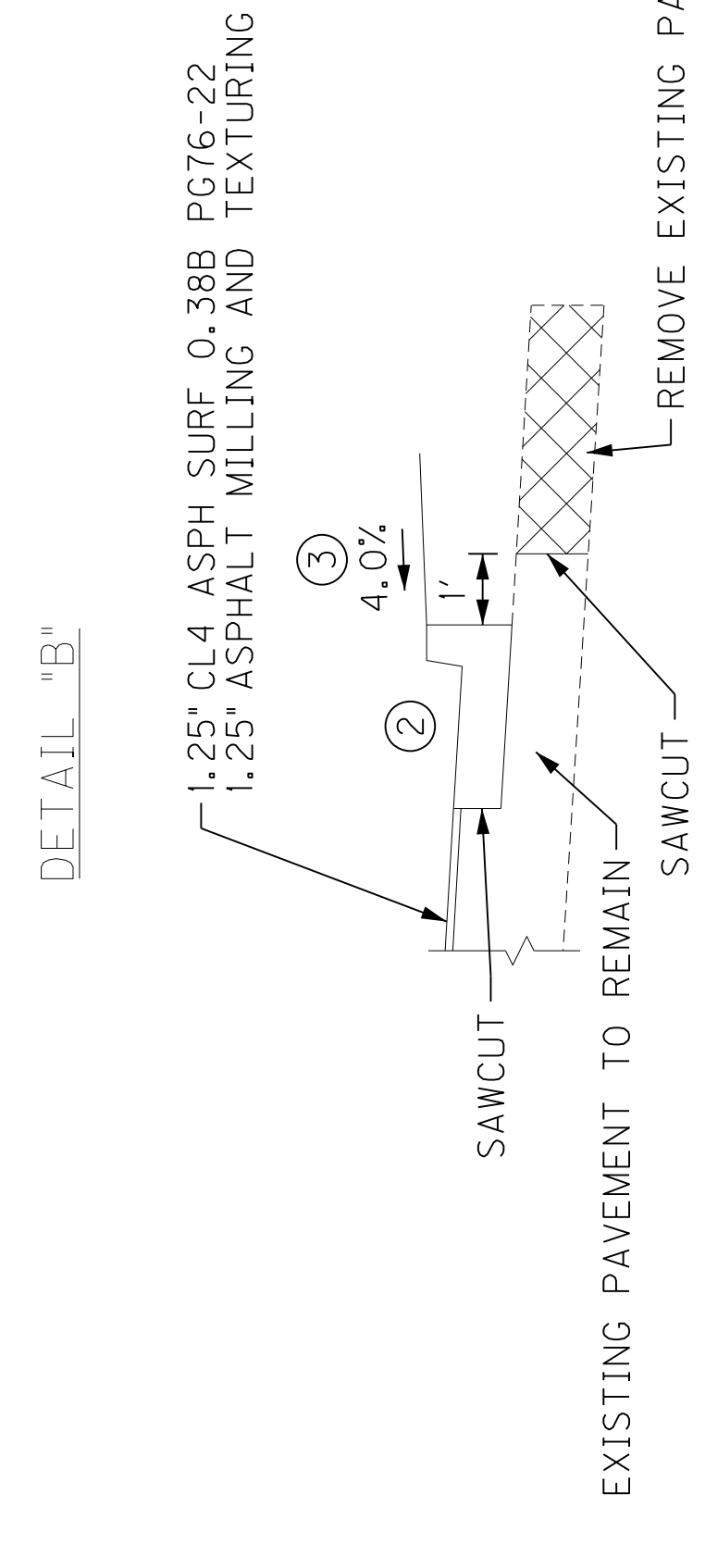
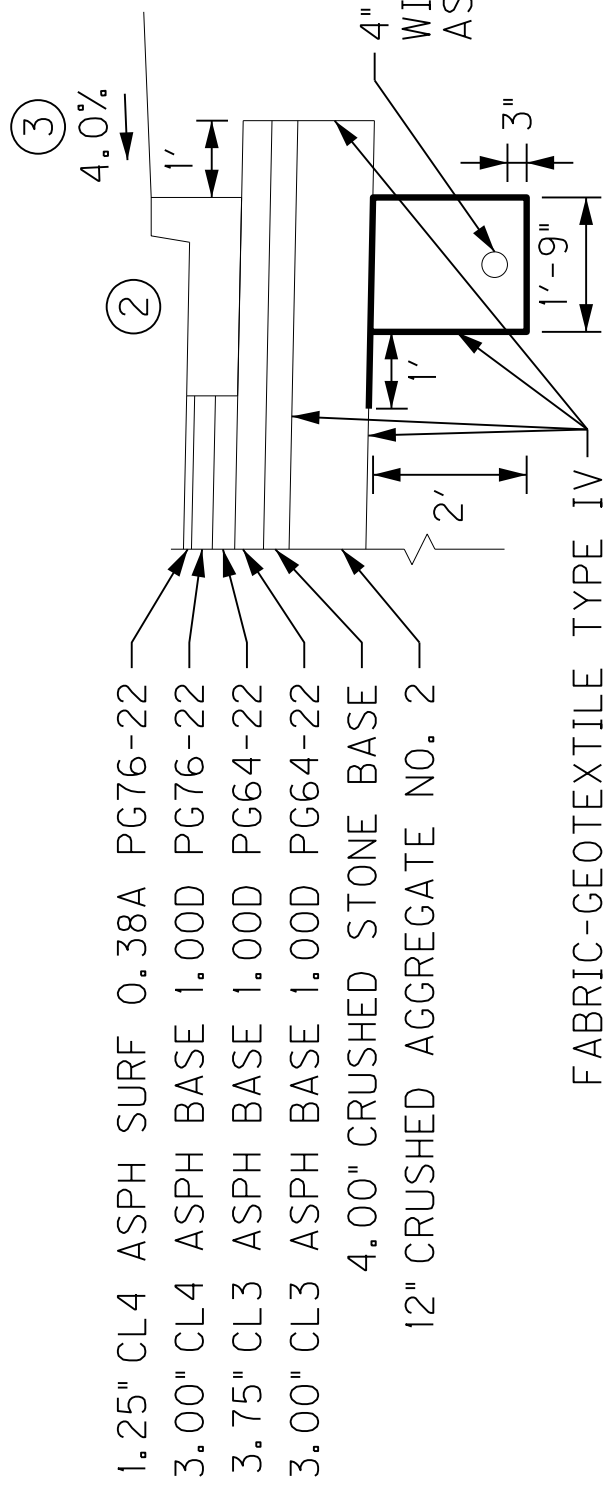
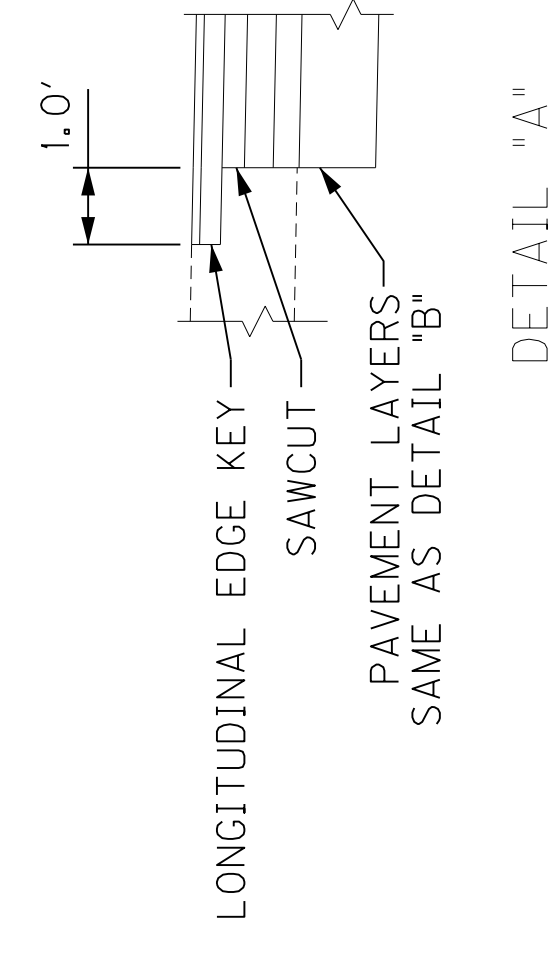
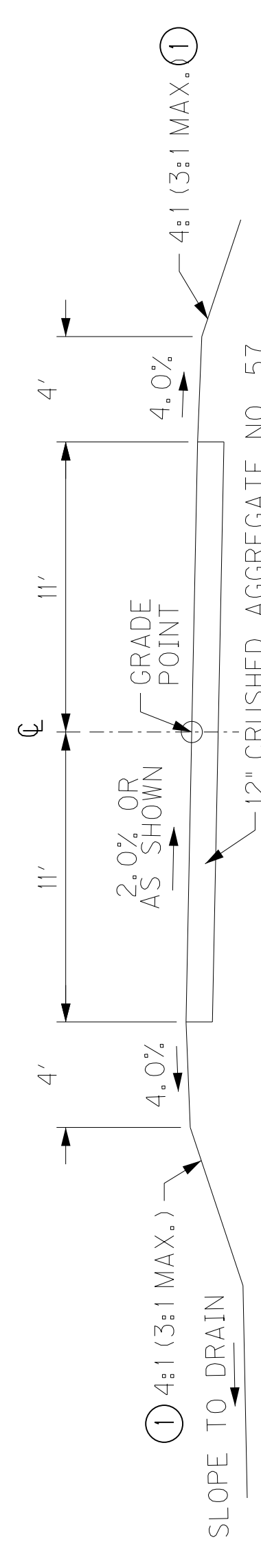

DETAIL "E"

COUNTY OF	ITEM NO.	SHEET NO.
BOONE	6-367.00	R2B

NEW CONSTRUCTION WITH ASPHALT PAVEMENT TRAFFIC LANES

- CRUSHED AGGREGATE NO. 2
SEE GEOTECHNICAL REPORT FOR GEOTEXTILE FABRIC RECOMMENDATIONS
- CRUSHED STONE BASE
- CL3 ASPH BASE 1,000 PG64-22
- CL3 ASPH BASE 1,000 PG64-22
- CL4 ASPH BASE 1,000 PG76-22
- CL4 ASPH SURFACE 0.38A PG76-22

- 12" DEPTH
- 4" DEPTH
- 3" DEPTH
- 3 3/4" DEPTH
- 3" DEPTH
- 1 1/4" DEPTH

SIDEWALK
DGA BASE
SIDEWALK-4 IN CONCRETE

4" DEPTH
4" DEPTH

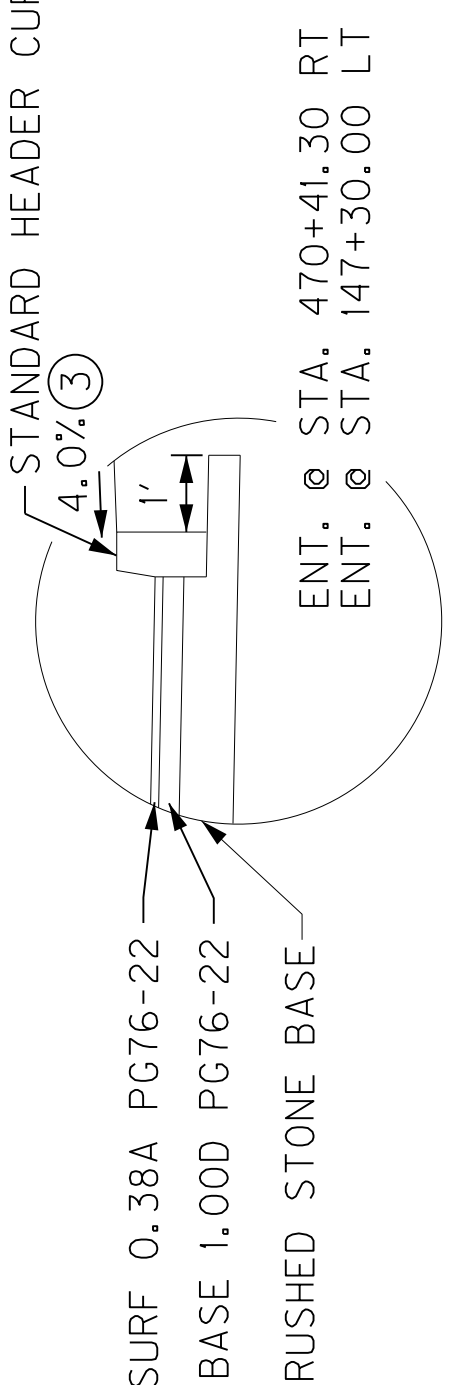
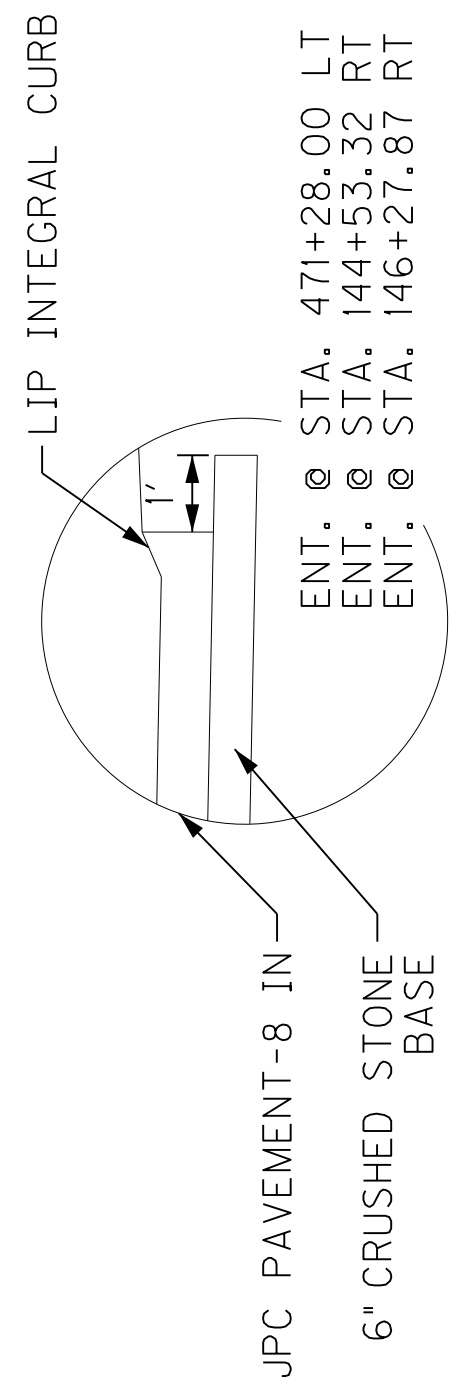
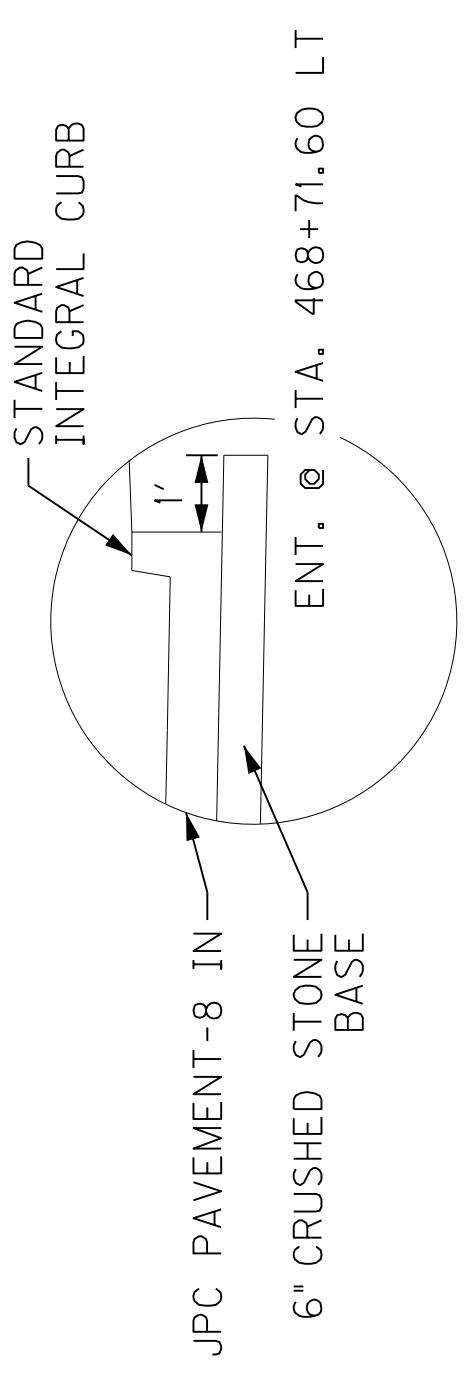

DETAIL "I"
ENTRANCES

SCALE: NTS

TYPICAL SECTIONS

QUADRANT ROAD AND ENTRANCES

GENERAL SUMMARY

ITEM	DESCRIPTION	UNIT	US 42	KY 842	QUADRANT ROAD	ENTRANCES	TOTAL
1	DCA BASE ④	TON	132	245	151		528
1000	PERFORATED PIPE-4 IN	LF		741	716		1457
1010	NON-PERFORATED PIPE-4 IN	LF		94	30		124
1024	PERF PIPE HEADWALL TY 2-4 IN	EACH		2			2
1310	REMOVE PIPE	LF	0	26	0	0	26
1585	REMOVE DROP BOX INLET	EACH	0	1	0		1
1705	REMOVE CURB & GUTTER BOX INLET	EACH	1	0	0		1
1810	STANDARD CURB AND GUTTER	LF	528	1872	1134	0	3534
1830	STANDARD INTEGRAL CURB	LF	0	0	0	73	73
1840	LIP INTEGRAL CURB	LF	97	0	0	541	638
1875	STANDARD HEADER CURB	LF	0	0	0	194	194
1904	REMOVE CURB	LF	215	347	0	138	700
1949	MOUNTABLE MEDIAN TYPE 6A	SO YD	98	144	0	0	242
1982	DELINEATOR FOR GUARDRAIL M/W	EACH		13	0		13
2015	CEMENT CONCRETE ISLAND	SO YD	0	0	0	184	184
2091	REMOVE PAVEMENT	SO YD	323	498	0	264	1085
2230	EMBANKMENT IN PLACE	CU YD	46	14,650	18,139	0	32835
2242	WATER	MGAL	8	397	148	25	577
2351	GUARDRAIL-STEEL W BEAM-S FACE	LF	0	657	13	0	670
2367	GUARDRAIL END TREATMENT TYPE 1	EACH	0	1	0	0	1
2369	GUARDRAIL END TREATMENT TYPE 2A	EACH	0	3	0	0	3
2381	REMOVE GUARDRAIL	LF	0	1242	0	0	1242
2391	GUARDRAIL END TREATMENT TYPE 4A	EACH		0	1		1
2429	RIGHT-OF-WAY MONUMENT TYPE 1	EACH	16	18	18		34
2432	WITNESS POST	EACH	16		18		34
2483	CHANNEL LINING CLASS II	TON		33			33
2484	CHANNEL LINING CLASS III	TON			23		23
2159	TEMP DITCH	LF					1000
2160	CLEAN TEMP DITCH	LF					1000
2701	TEMP SILT FENCE	LF					2000
2703	SILT TRAP TYPE A	EACH					40
2704	SILT TRAP TYPE B	EACH					40
2705	SILT TRAP TYPE C	EACH					15
2706	CLEAN SILT TRAP TYPE A	EACH					120
2707	CLEAN SILT TRAP TYPE B	EACH					120
2708	CLEAN SILT TRAP TYPE C	EACH					45
5952	TEMP MULCH	SY					25000
5953	TEMP SEEDING AND PROTECTION	SY					25000
2545	CLEARING AND GRUBBING ②	LS					1
2568	MOBILIZATION	LS					1
2569	MOBILIZATION	LS					1
2596	FABRIC-GEOTEXTILE TYPE I	SO YD		③ 52	31		83
2599	FABRIC-GEOTEXTILE TYPE IV	SO YD		3040	676		3716
2625	REMOVE HEADWALL	EACH	0	2	0	0	2
2650	MAINTAIN & CONTROL TRAFFIC	LS					1
2690	SAFELoADING	CY	0	20	0	0	20
2720	SIDEWALK-4 IN CONCRETE	SO YD	574	1059	657	0	2290
2726	STAKING	LS					1
2585	EDGE KEY	LF	240	940			1180
5950	EROSION CONTROL BLANKET	SO YD	0	43	456	0	499
5963	INITIAL FERTILIZER	TON	0.04	0.3	0.1		0.5
5964	20-10-10 FERTILIZER	TON	0.1	0.6	0.2		0.8
5985	SEEDING AND PROTECTION	SO YD	903	9923	3146		13972
5990	SODDING	SO YD	534	999	474		2007
5992	AGRICULTURAL LIMESTONE	TON		3	3		6
10020NS	FUEL ADJUSTMENT	DOLLAR					15318
10030NS	ASPHALT ADJUSTMENT	DOLLAR					22687

ITEM	DESCRIPTION	UNIT	US 42	KY 842	QUADRANT ROAD	ENTRANCES	TOTAL
6514	PAVE STRIPING-PERM PAINT-4 IN	LF					19174
6565	PAVE MARKING-THERMO X-WALK-6 IN	LF					1534
6567	PAVE MARKING-THERMO STOP BAR-12IN	LF					329
6571	PAVE MARKING-PAINT PARKING LOT	LF					140
6572	PAVE MARKING-DOTTED LANE EXTEN	LF					80
6573	PAVE MARKING-THERMO STR ARROW	EACH					16
6574	PAVE MARKING-THERMO CURV ARROW	EACH					50
6575	PAVE MARKING-THERMO COMB ARROW	EACH					2
24910EC	PAVE MARKING-THERMO NO LEFT TURN	EACH					4
6589	PAVEMENT MARKER TYPE V-MW	EACH					100
6591	PAVEMENT MARKER TYPE V-BY	EACH					98
21373ND	REMOVE SIGN	EACH				1	1
23158ES505	DETECTABLE WARNINGS	SO FT	235	373	64	0	672
23275ENIIF	TURF REINFORCEMENT MAT 2	SO YD		701	182		883
23322EC	AGGREGATE SIZE NO. 57	CY		86	84		170
20072ES805	GRANULAR EMBANKMENT	TON		1480			1480
24631EC	BARCODE SIGN INVENTORY	EACH	45	51	17	18	131

③

NOTES

① ESTIMATE FOR EARTHWORK CALCULATIONS ARE FOR DESIGN ONLY. THE CONTRACTOR IS ADVISED THAT THE CALCULATIONS SHOWN ARE FOR INFORMATION ONLY. ASSUMPTIONS FOR SHRINKAGE AND SWELL FACTORS ARE THE CONTRACTOR'S RESPONSIBILITY.

② APPROXIMATELY 10.22 ACRES.

③ SEE SHEET R2F FOR EXPLANATION OF ADDITIONAL QUANTITIES.

④ UNDER SIDEWALKS

⑤ AT PROJECT COMPLETION THE TEMP CONCRETE BARRIER WALL SHALL BECOME THE PROPERTY OF THE CONTRACTOR.

<i>EARTHWORK QUANTITIES</i> ①
<i>COM (INCLUDING EMB BENCHES)</i> = 8,385
<i>EMB BENCH</i> = 29,976
<i>EMB BENCH</i> = 2,859
<i>TOTAL EMB</i> = 32,835

MAINTENANCE OF TRAFFIC SUMMARY

ITEM	DESCRIPTION	UNIT	QUANTITY
01984	DELINEATOR FOR BARRIER - WHITE	EACH	24
01992	INSTALL TEMP CONCRETE BARRIER	LF	1200
02002	REMOVE TEMP CONC BARRIER WALL ⑤	LF	1200
02003	RELOCATE TEMP CONC BARRIER	LF	600
02014	BARRICADE-TYPE III	EACH	8
02562	TEMPORARY SIGNS	SO FT	2000
02775	ARROW PANEL	EACH	2
02900	INSTALL TEMP CRASH CUSHION	EACH	4
03171	CONCRETE BARRIER WALL TYPE 9T	LF	1200
04936	MAINTAIN SIGNAL OPERATION	LS	1
06510	PAVE STRIPING-TEMP PAINT-4IN.	LF	50,000
06530	PAVE STRIPING-REMOVAL-4 IN.	LF	5,000
06550	PAVE STRIPING-TEMP REM TAPE-W	LF	1,500
06551	PAVE STRIPING-TEMP REM TAPE-Y	LF	1,000
06533	PAVE STRIPING-REMOVAL-12 IN.	LF	200
06588	PAVEMENT MARKER TY IVA-BY TEMP	EACH	100
06598	PAVEMENT MARKING REMOVAL	SO FT	100
06600	REMOVE PAVEMENT MARKER TYPE V	EACH	80
08901	CRASH CUSHION TY VI CLASS BT TL2	EACH	2

GENERAL SUMMARY SHEET

GENERAL SUMMARY

ITEM	DESCRIPTION	UNIT	US 42	KY 842	QUADRANT ROAD	ENTRANCES	TOTAL
1	DCA BASE ④	TON	132	245	151		528
1000	PERFORATED PIPE 4 IN	LF		741	716		1457
1010	NON-PERFORATED PIPE-4 IN	LF		94	30		124
1024	PERF PIPE HEADWALL TY 2-4 IN	LF		26	0	0	26
1310	REMOVE PIPE	EACH	0	1	0		1
1585	REMOVE DROP BOX INLET	EACH	0	0	0		0
1705	REMOVE CURB & GUTTER BOX INLET	EACH	1	0	0		1
1810	STANDARD CURB AND GUTTER	LF	528	1872	1134	0	3534
1830	STANDARD INTEGRAL CURB	LF	0	0	0	73	73
1840	LIP INTEGRAL CURB	LF	97	0	0	541	638
1875	STANDARD HEADER CURB	LF	0	0	0	194	194
1904	REMOVE CURB	LF	215	347	0	138	700
1949	MOUNTABLE MEDIAN TYPE 6A	SO YD	98	144	0	0	242
1982	DELINEATOR FOR GUARDRAIL M/W	EACH		13	0		13
2015	CEMENT CONCRETE ISLAND	SO YD	0	0	0	184	184
2091	REMOVE PAVEMENT	SO YD	323	498	0	264	1085
2230	EMBANKMENT IN PLACE	CU YD	46	14,650	18,139	0	32835
2242	WATER	MGAL	8	397	148	25	577
2351	GUARDRAIL-STEEL W BEAM-S FACE	LF	0	657	13	0	670
2367	GUARDRAIL END TREATMENT TYPE 1	EACH	0	1	0	0	1
2369	GUARDRAIL END TREATMENT TYPE 2A	EACH	0	3	0	0	3
2381	REMOVE GUARDRAIL	LF	0	1242	0	0	1242
2391	GUARDRAIL END TREATMENT TYPE 4A	EACH		0	1		1
2429	RIGHT-OF-WAY MONUMENT TYPE 1	EACH	16	18	18		34
2432	WITNESS POST	EACH	16				34
2483	CHANNEL LINING CLASS II	TON		33			33
2484	CHANNEL LINING CLASS III	TON			23		23
2159	TEMP DITCH	LF					1000
2160	CLEAN TEMP DITCH	LF					1000
2701	TEMP SILT FENCE	LF					2000
2703	SILT TRAP TYPE A	EACH					40
2704	SILT TRAP TYPE B	EACH					40
2705	SILT TRAP TYPE C	EACH					15
2706	CLEAN SILT TRAP TYPE A	EACH					120
2707	CLEAN SILT TRAP TYPE B	EACH					120
2708	CLEAN SILT TRAP TYPE C	EACH					45
5952	TEMP MULCH	SY					25000
5953	TEMP SEEDING AND PROTECTION	SY					25000
2545	CLEARING AND GRUBBING ②	LS					1
2568	MOBILIZATION	LS					1
2569	DEMOLITION	LS					1
2596	FABRIC-GEOTEXTILE TYPE I	SO YD		③ 52	31		83
2599	FABRIC-GEOTEXTILE TYPE IV	SO YD		3040	676		3716
2625	REMOVE HEADWALL	EACH	0	2	0	0	2
2650	MAINTAIN & CONTROL TRAFFIC	LS					1
2690	SAFELOADING	CY	0	20	0	0	20
2720	SIDEWALK-4 IN CONCRETE	SO YD	574	1059	657	0	2290
2726	STAKING	LS					1
2585	EDGE KEY	LF	240	940			1180
5950	EROSION CONTROL BLANKET	SO YD	0	43	456	0	499
5963	INITIAL FERTILIZER	TON	0.04	0.3	0.1		0.5
5964	20-10-10 FERTILIZER	TON	0.1	0.6	0.2		0.8
5985	SEEDING AND PROTECTION	SO YD	903	9923	3146		13972
5990	SODDING	SO YD	534	999	474		2007
5992	AGRICULTURAL LIMESTONE	TON		3	3		6
10020NS	FUEL ADJUSTMENT	DOLLAR					15318
10030NS	ASPHALT ADJUSTMENT	DOLLAR					22687

ITEM	DESCRIPTION	UNIT	US 42	KY 842	QUADRANT ROAD	ENTRANCES	TOTAL
6514	PAVE STRIPING-PERM PAINT-4 IN	LF					19174
6565	PAVE MARKING-THERMO X-WALK-6 IN	LF					1534
6567	PAVE MARKING-THERMO STOP BAR-12IN	LF					329
6571	PAVE MARKING-PAINT PARKING LOT	LF					140
6572	PAVE MARKING-DOTTED LANE EXTEN	LF					80
6573	PAVE MARKING-THERMO STR ARROW	EACH					16
6574	PAVE MARKING-THERMO CURV ARROW	EACH					50
6575	PAVE MARKING-THERMO COMB ARROW	EACH					2
24910EC	PAVE MARKING-THERMO NO LEFT TURN	EACH					4
6589	PAVEMENT MARKER TYPE V-MW	EACH					100
6591	PAVEMENT MARKER TYPE V-BY	EACH					98
21373ND	REMOVE SIGN	EACH				1	1
23158ES505	DETECTABLE WARNINGS	SO FT	235	373	64	0	672
23275ENIIF	TURF REINFORCEMENT MAT 2	SO YD		701	182		883
23322EC	AGGREGATE SIZE NO. 57	CY		86	84		170
20072ES805	GRANULAR EMBANKMENT	TON		1480			1480
24631EC	BARCODE SIGN INVENTORY	EACH	45	51	17	18	131

NOTES
 ① ESTIMATE FOR EARTHWORK CALCULATIONS ARE FOR DESIGN ONLY. THE CONTRACTOR IS ADVISED THAT THE CALCULATIONS SHOWN ARE FOR INFORMATION ONLY. ASSUMPTIONS FOR SHRINKAGE AND SWELL FACTORS ARE THE CONTRACTOR'S RESPONSIBILITY.
 ② APPROXIMATELY 10.22 ACRES.
 ③ SEE SHEET R2F FOR EXPLANATION OF ADDITIONAL QUANTITIES.
 ④ UNDER SIDEWALKS
 ⑤ AT PROJECT COMPLETION THE TEMP CONCRETE BARRIER WALL SHALL BECOME THE PROPERTY OF THE CONTRACTOR.

MAINTENANCE OF TRAFFIC SUMMARY

ITEM	DESCRIPTION	UNIT	QUANTITY
01984	DELINEATOR FOR BARRIER - WHITE	EACH	24
01992	INSTALL TEMP CONCRETE BARRIER	LF	1200
02002	REMOVE TEMP CONC BARRIER WALL ⑤	LF	1200
02003	RELOCATE TEMP CONC BARRIER	LF	600
02014	BARRICADE-TYPE III	EACH	8
02562	TEMPORARY SIGNS	SO FT	2000
02775	ARROW PANEL	EACH	2
02900	INSTALL TEMP CRASH CUSHION	EACH	4
03171	CONCRETE BARRIER WALL TYPE 9T	LF	1200
04936	MAINTAIN SIGNAL OPERATION	LS	1
06510	PAVE STRIPING-TEMP PAINT-4IN.	LF	50,000
06530	PAVE STRIPING-REMOVAL-4 IN.	LF	5,000
06550	PAVE STRIPING-TEMP REM TAPE-W	LF	1,500
06551	PAVE STRIPING-TEMP REM TAPE-Y	LF	1,000
06533	PAVE STRIPING-REMOVAL-12 IN.	LF	200
06588	PAVEMENT MARKER TY IVA-BY TEMP	EACH	100
06598	PAVEMENT MARKING REMOVAL	SO FT	100
06600	REMOVE PAVEMENT MARKER TYPE V	EACH	80
08901	CRASH CUSHION TY VI CLASS BT TL2	EACH	2

EARTHWORK QUANTITIES ①
COM (INCLUDING EMB BENCHES) = 8,385
EMB BENCH = 29,976
EMB BENCH = 2,859
TOTAL EMB = 32,835

PAVING SUMMARY

ITEM CODE	ITEM	UNIT	US 42	KY 842	QUADRANT ROAD	ENTRANCES	TOTAL PROJECT
3	CRUSHED STONE BASE	TON	184	684	1364	903	3135
5	GEOGRID REINFORCEMENT FOR SUBGRADE	SQ YD	227	1914	5272		7413
71	CRUSHED AGGREGATE NO. 57	TON				368	368
78	CRUSHED AGGREGATE SIZE NO. 2	TON	157	1321	3638		5116
214	CL3 ASPH BASE 1.00D PG64-22	TON	76	623	1835		2534
219	CL4 ASPH BASE 1.00D PG76-22	TON	31	247	772	289	1339
342	CL4 ASPH SURF 0.38A PG76-22	TON	726	593	322	289	1930
356	ASPHALT MATERIAL FOR TACK	TON	0	1	2	0	3
2101	CEMENT CONCRETE ENTRANCE PAVEMENT-8 IN	SQ YD				2087	2087
2676	MOBILIZATION FOR MILL AND TEXT	LS					1
2677	ASPHALT PAVE MILLING & TEXTURING	TON	713	490			1203
20550ND	SAWCUT PAVEMENT	LF	802	768		837	2407

PAVING AREAS

ITEM	US 42	KY 842	QUADRANT ROAD	ENTRANCES	QUADRANT ROAD	ENTRANCES	TOTAL PROJECT
GEOGRID REINFORCEMENT FOR SUBGRADE	227	1914	5272				7413
1.25" CL4 ASPHALT SURFACE COURSE 0.38A PG76-22	10556	8626	4679	301			24162
3" CL4 ASPHALT BASE 1.00D PG76-22	190	1495	4679	301			6665
3.75" CL3 ASPHALT BASE 1.00D PG64-22	190	1495	4679				6364
3" CL3 ASPHALT BASE 1.00D PG64-22	227	1914	5272				7413
4" CRUSHED STONE BASE	227	1914	5272				7413
12" CRUSHED AGGREGATE NO. 2	227	1914	5272				7413
ASPHALT PAVE MILLING & TEXTURING	10366	7131					17497
6" CRUSHED STONE BASE				2616			2616
12" CRUSHED AGGREGATE NO. 57				534			534
CEMENT CONCRETE ENTRANCE PAVEMENT-8 IN				2087			2087

NOTES

ALL ASPHALT MIXTURES SHALL BE ESTIMATED AT 110 LBS. PER SQ. YD. PER INCH OF DEPTH, UNLESS NOTED OTHERWISE.

ALL AGGREGATE MIXTURES SHALL BE ESTIMATED AT 115 LBS PER SQ. YD. PER INCH OF DEPTH, UNLESS NOTED OTHERWISE.

COUNTY OF	ITEM NO.	SHEET NO.
BOONE	6-367.00	R2D

PAVING SUMMARY

ITEM CODE	ITEM	UNIT	US 42	KY 842	QUADRANT ROAD	ENTRANCES	TOTAL PROJECT
3	CRUSHED STONE BASE	TON	184	684	1364	903	3135
5	GEOGRID REINFORCEMENT FOR SUBGRADE	SQ YD	227	1914	5272		7413
71	CRUSHED AGGREGATE NO. 57	TON				368	368
78	CRUSHED AGGREGATE SIZE NO. 2	TON	157	1321	3638		5116
214	CL3 ASPH BASE 1.00D PG64-22	TON	76	623	1835		2534
219	CL4 ASPH BASE 1.00D PG76-22	TON	31	247	772	289	1339
342	CL4 ASPH SURF 0.38A PG76-22	TON	726	593	322	289	1930
356	ASPHALT MATERIAL FOR TACK	TON	0	1	2	0	3
2101	CEMENT CONCRETE ENTRANCE PAVEMENT-8 IN	SQ YD				2087	2087
2676	MOBILIZATION FOR MILL AND TEXT	LS					1
2677	ASPHALT PAVE MILLING & TEXTURING	TON	713	490			1203
20550ND	SAWCUT PAVEMENT	LF	802	768		837	2407

PAVING AREAS

ITEM	US 42	KY 842	QUADRANT ROAD	ENTRANCES	TOTAL PROJECT
GEOGRID REINFORCEMENT FOR SUBGRADE	227	1914	5272		7413
1.25" CL4 ASPHALT SURFACE COURSE 0.38A PG76-22	10556	8626	4679	301	24162
3" CL4 ASPHALT BASE 1.00D PG76-22	190	1495	4679	301	6665
3.75" CL3 ASPHALT BASE 1.00D PG64-22	190	1495	4679		6364
3" CL3 ASPHALT BASE 1.00D PG64-22	227	1914	5272		7413
4" CRUSHED STONE BASE	227	1914	5272		7413
12" CRUSHED AGGREGATE NO. 2	227	1914	5272		7413
ASPHALT PAVE MILLING & TEXTURING	10366	7131			17497
6" CRUSHED STONE BASE				2616	2616
12" CRUSHED AGGREGATE NO. 57				534	534
CEMENT CONCRETE ENTRANCE PAVEMENT-8 IN				2087	2087

NOTES

ALL ASPHALT MIXTURES SHALL BE ESTIMATED AT 110 LBS. PER SQ. YD. PER INCH OF DEPTH, UNLESS NOTED OTHERWISE.

ALL AGGREGATE MIXTURES SHALL BE ESTIMATED AT 115 LBS PER SQ. YD. PER INCH OF DEPTH, UNLESS NOTED OTHERWISE.

REMOVE NOTE 1

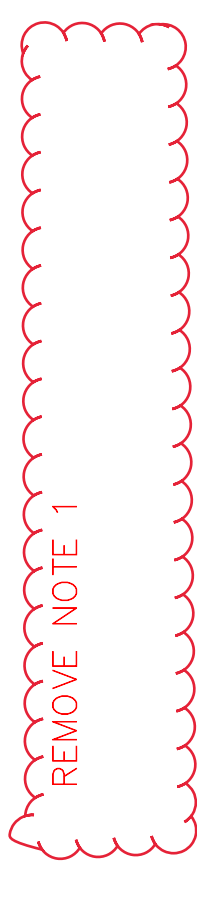

COUNTY OF	ITEM NO.	SHEET NO.
BOONE	6-367.00	R2D